

IMPORTANT INFORMATION
 Dimensions to be confirmed on site prior to start of works and ODAS is to be informed of discrepancies immediately. No dimensions to be scaled from this drawing.
 All materials and works are to be carried out in accordance with current British Standards, Planning Approval, current Building Regulations and Codes of Practice.
 Party Wall Act -
 Notices under the Party Wall Act are to be served by the property owner or appointed third party by property owner.
 Health and Safety -
 CDM 2015 Regulations apply to all construction works to be carried out and apply to designers, contractors and the client. As such all parties have duties under these regulations.

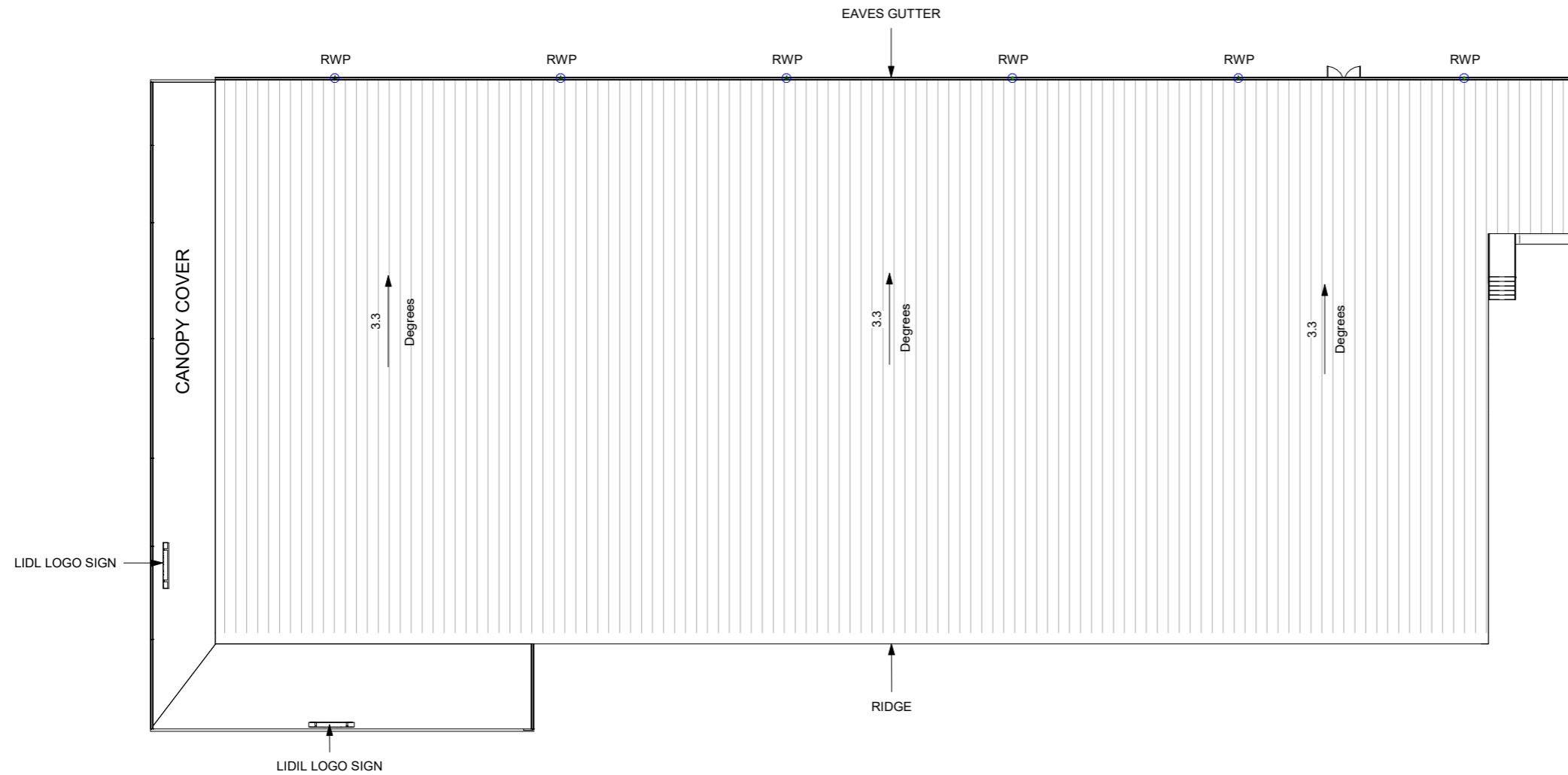

1 Roof
1 : 200

Amendments

Drawing Status: Planning

Client:
LIDL UK GMBH - FOXES PARK, BROWNHILL WAY,
NURSLING, SOUTHMPPTON, HAMPSHIRE, SO16 0AW

Project Name:
NEW LIDL STORE, BROWNHILL WAY

Drawing Title:
ROOF

Project No: 17109

Drawing No: AD112

Drawn: EB

Reviewed: SN

Date: 17 April 2018

Scale @ A2: 1 : 200

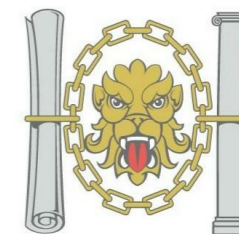

Charter Institute of
Architectural Technologists
Registered Practice

One Design Architectural Services Ltd
Unit 1 Merchants Quay,
Phase II, Ashley Lane, Shipley,
West Yorkshire, BD17 7DB
Tel: 01274 591188

www.onedesignarchs.com
mail@onedesignarchs.com

ONE DESIGN
ARCHITECTURAL SERVICES