

1 **Ground Floor**
1 : 200

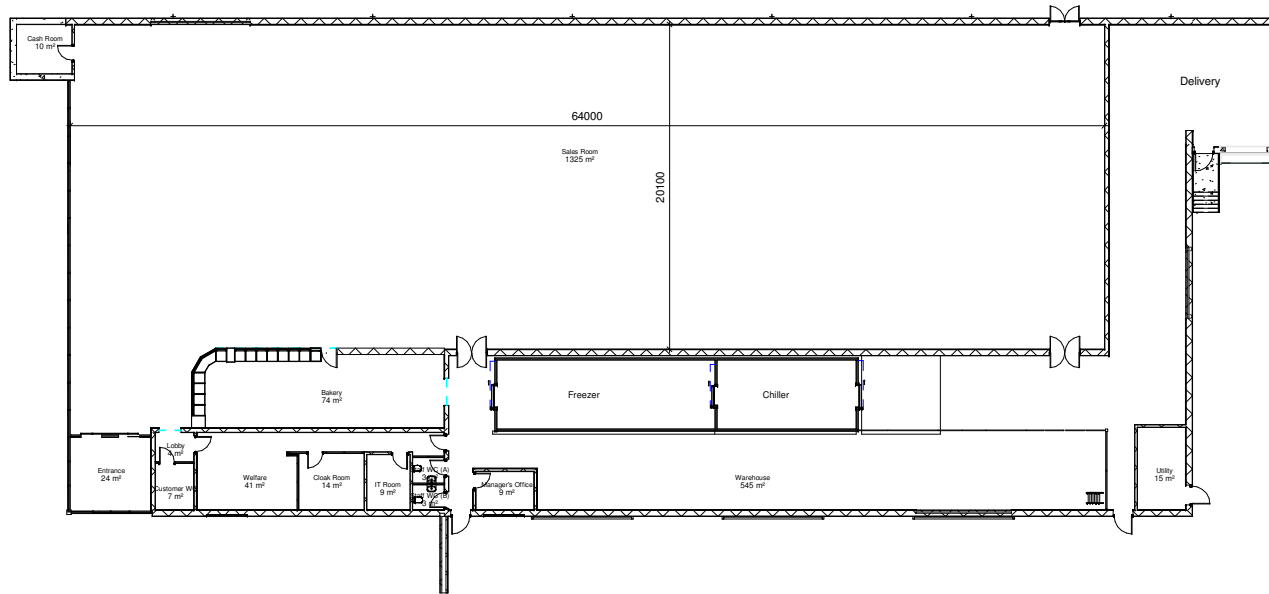

IMPORTANT INFORMATION
Dimensions to be confirmed on site prior to start of works and ODAS is to be informed of discrepancies immediately. No dimensions to be scaled from this drawing.
All materials and works are to be carried out in accordance with current British Standards, Planning Approval, current Building Regulations and Codes of Practice.
Party Wall Act.
Notices under the Party Wall Act are to be served by the property owner or appointed third party by property owner.
Health and Safety.
CDM 2015 Regulations apply to all construction works to be carried out and apply to designers, contractors and the client. As such all parties have duties under these regulations.

Amendments	
Drawing Status:	Planning

Client:
LIDL UK GMBH - FOXES PARK, BROWN HILL WAY,
NURSILING, SOUTHAMPTON, HAMPSHIRE, SO16 0AW

Project Name:
NEW LIDL STORE, BROWN HILL WAY

Drawing Title:
PROPOSED FLOOR PLAN

Project No: 17109
Drawing No: AD 111
Drawn: EB
Reviewed: SN
Date: 10 May 2018
Scale @ A2: As indicated

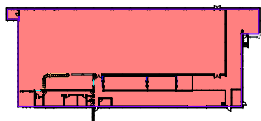

2 **GIA - Gross Internal Area - 2125m²**
1 : 1000

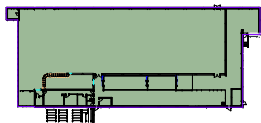

3 **Building's Foot print excluding Canopy - 2205m²**
1 : 1000

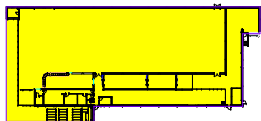

4 **Building's Foot print including Canopy - 2427m²**
1 : 1000

Room Schedule	
Name	Area
Bakery	74 m ²
Cash Room	10 m ²
Cloak Room	14 m ²
Customer WC	7 m ²
Entrance	24 m ²
IT Room	9 m ²
Lobby	4 m ²
Manager's Office	9 m ²
Sales Room	1325 m ²
Staff WC (A)	3 m ²
Staff WC (B)	3 m ²
Utility	15 m ²
Warehouse	545 m ²
Welfare	41 m ²
Grand total: 14	2085 m ²

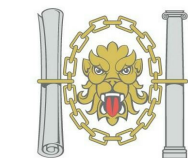

Charter Institute of
Architectural Technologists
Registered Practice

One Design Architectural Services Ltd
Unit 1 Merchants Quay,
Phase II, Ashley Lane, Shipley,
West Yorkshire, BD17 7DB
Tel: 01274 591188

www.onedesignarchs.com
mail@onedesignarchs.com

ONE DESIGN
ARCHITECTURAL SERVICES