

IMPORTANT INFORMATION
 Dimensions to be confirmed on site prior to start of works and CDM 15 to be informed of discrepancies immediately. No dimensions to be scaled from this drawing.
 All materials and works are to be carried out in accordance with current British Standards, Planning Approval, current Building Regulations and Codes of Practice.
 Party Wall Act -
 Notices under the Party Wall Act are to be served by the property owner or appointed third party by property owner.
 Health and Safety -
 CDM 2015 Regulations apply to all construction works to be carried out and apply to designers, contractors and the client. As such all parties have duties under these regulations.

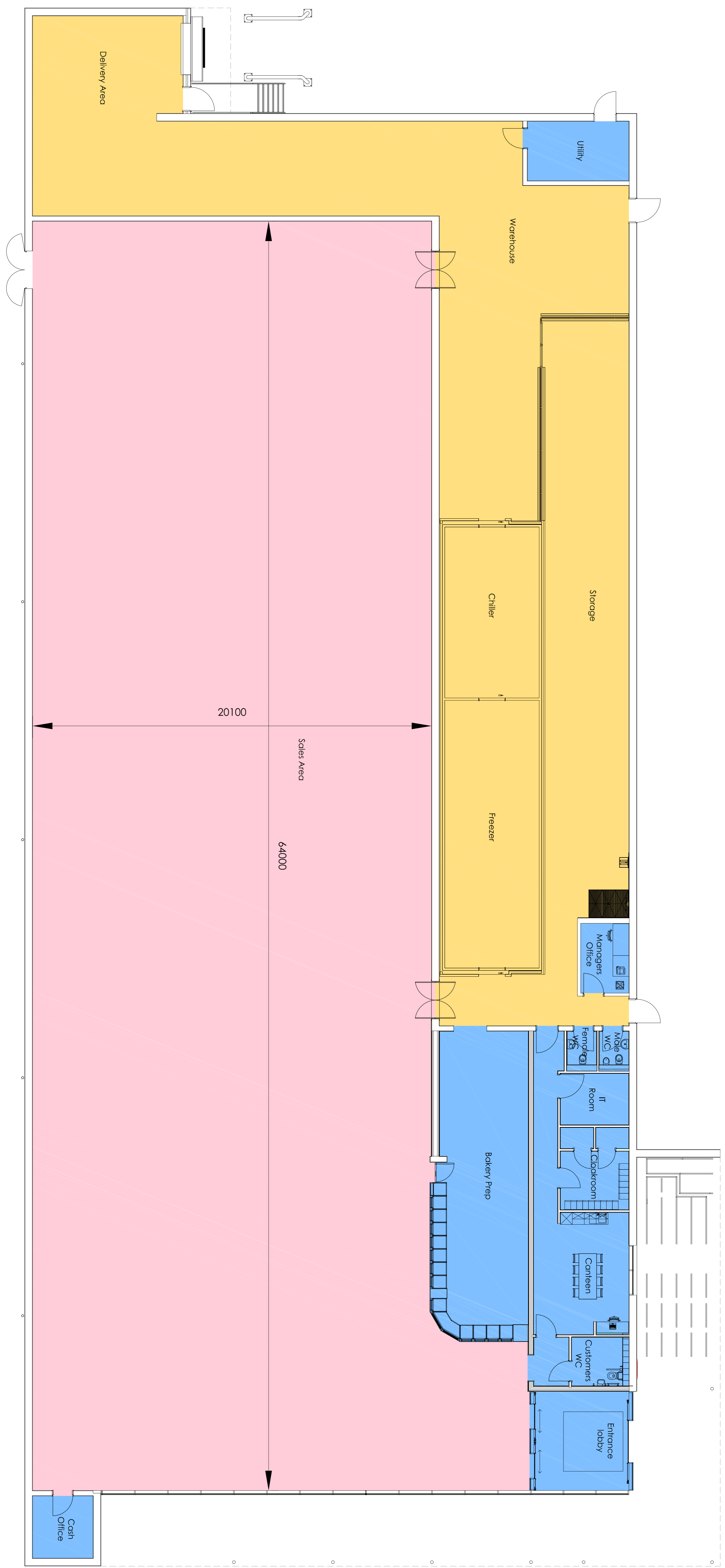

Rev	Date	Description	Revised by	Checked by
Amendments				

STATUS: PLANNING

Client
 LIDL UK GMBH - BROWN HILL WAY,
 SOUTHAMPTON, SO16 0AW
Project
 THE AVENUE, SOUTHAMPTON

Title
 PROPOSED BUILDING PLAN

Job No. 17143
Drawing No. AD 111
Drawn by JA
Checked by SPN
Date SEPT 2017
Scale 1:100
Sheet A1

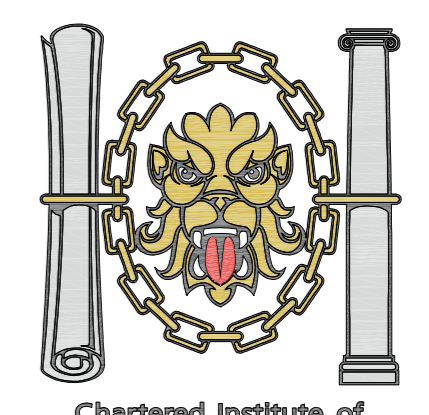

Chartered Institute of Architectural Technologists
 Registered Practice
 One Design Architectural Services Ltd
 Unit 1, Merchants Quay,
 Phase II, Ashley Lane, Shipley
 West Yorkshire, BD17 7DB
 0 1 2 7 4 5 9 1 1 8 8
 www.onedesignarchs.com
 mail@onedesignarchs.com

ONE DESIGN
 ARCHITECTURAL SERVICES